UNITE® 180 4K Panoramic Camera



ClearOne® Contacts

Headquarters

5225 Wiley Post Way Suite 500
Salt Lake City, UT 84116

Sales

Tel: +1.801.975.7200
sales@clearone.com

Headquarters

Tel: +1.801.975-7200

Technical Support

Tel: +1.801.974.3760
videotechsupport@clearone.com

Notices

© 2021 ClearOne, Inc. ClearOne, Inc. All rights reserved.

Information in this document is subject to change without notice.

Document: DOC-0477-001v1.1 September 2021

Contents

Notices	i
Introduction	1
The UNITE 180 4K Panoramic Camera	1
PanoCAM Studio Camera Software	1
Related Links	1
Installing the Software	2
Windows Operating System	2
Mac Operating System (Mac OS)	5
Launching Studio with Any Application	7
The PanoCAM Studio Interface	9
1. Preview Window Position	10
2. Manual Boxes	11
3. Display Layouts	11
4. Image Mirror	14
5. Auto-Detect	15
6. Auto-Tracking	16
7. Effect (Light Settings)	16
8. Window Vertical Slider	17

Introduction

The UNITE 180 4K Panoramic Camera

UNITE 180 4K Panoramic Camera provides a full 180-degree panoramic field-of-view with “real-time stitching” to achieve a variety of useful viewing modes for any application and environment.

UNITE 180 is ready to use right out of the box. The camera itself has 6 viewing modes. Details are in the Quick-Start Guide.

PanoCAM Studio Camera Software

To use the camera’s advanced features, access the PanoCAM Studio software.

This user manual provides detailed information about use of the PanoCAM Studio software.

Related Links

- [Datasheet](#)
- [Quick-Start Guide](#)

Installing the Software

Windows Operating System

To install PanoCAM Studio on a computer with Windows, complete the following steps:

1. **Connect** the **UNITE 180 camera** to your computer's USB port.
Windows displays the software's .exe file as if it was on a CD drive.
2. **Double-click** the **.exe file**.

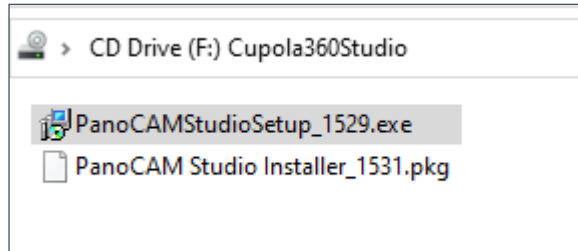

3. **Select** your preferred folder **location**, then **click Next**.

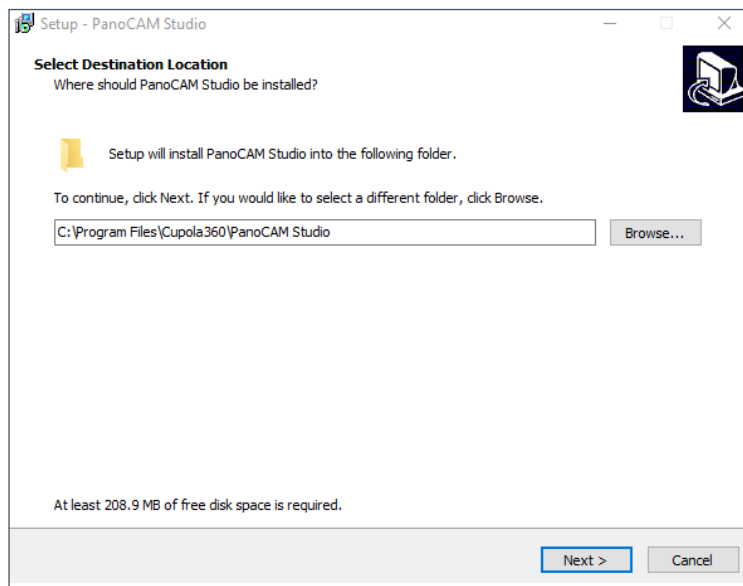

4. On the Ready to Install dialog window, **click Install**.

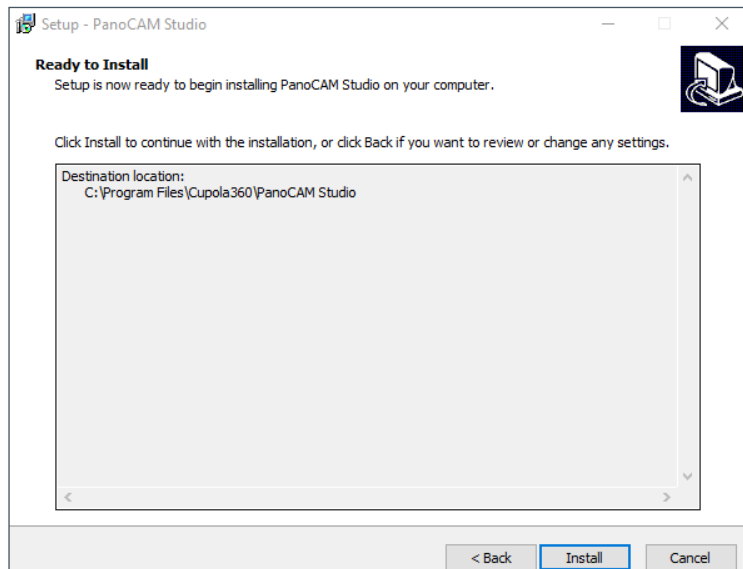

The software displays the Installing window,

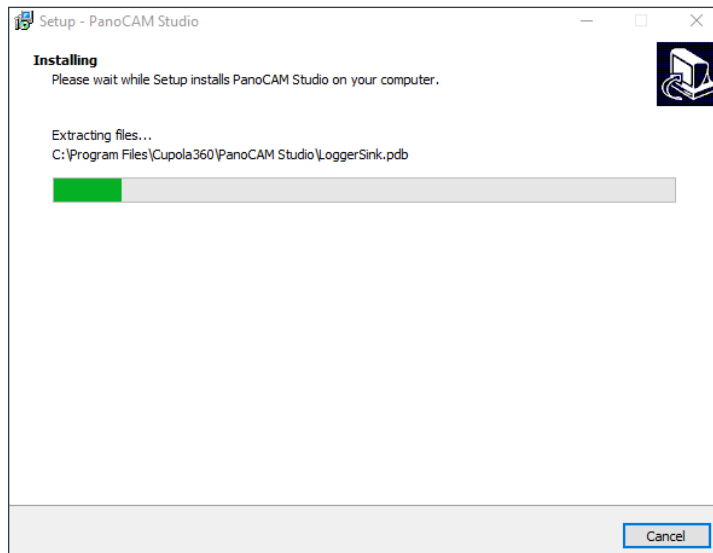

and then the Completing the PanoCAM Studio Setup Wizard screen:

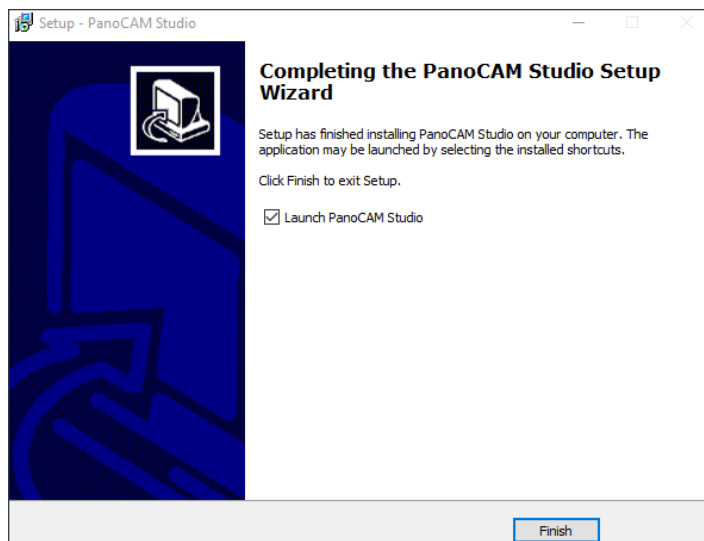

The setup wizard places a shortcut on your desktop, and launches Studio.

5. Click the **Launch PanoCAM Studio** checkbox, then **click Finish**.

The setup wizard places a shortcut () on your desktop, and launches Studio.

Studio displays a set of informative windows, beginning with Manual selection.

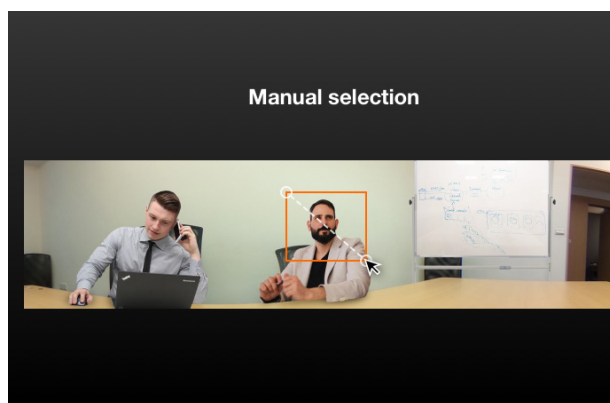

After you click Skip, or at the end of the information windows, Studio activates the camera and displays a window similar to the following:

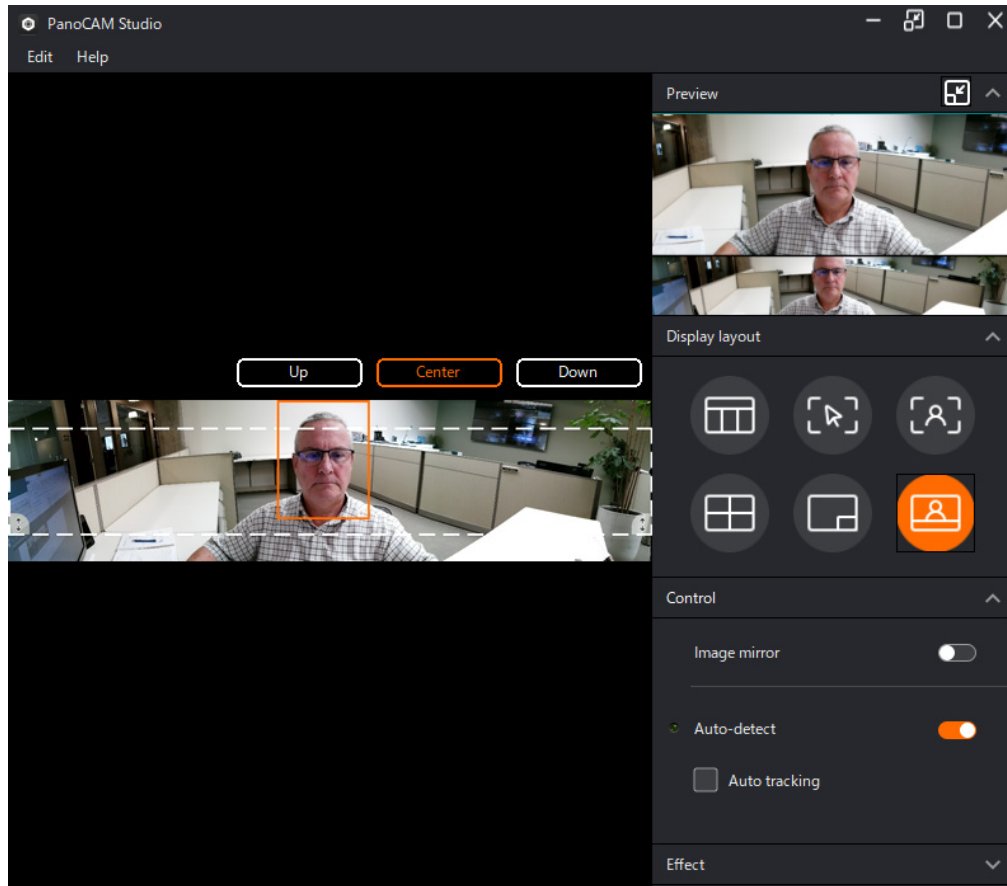

Mac Operating System (Mac OS)

To install PanoCAM Studio (Cupola360Studio) on a Mac, complete the following steps:

1. **Connect the UNITE 180 camera** to your computer's USB port.

Mac OS displays the Cupola360Studio icon on your desktop:



2. **Double-click the icon.**
3. **Double-click PanoCAM Studio Installer_1531.pkg.**

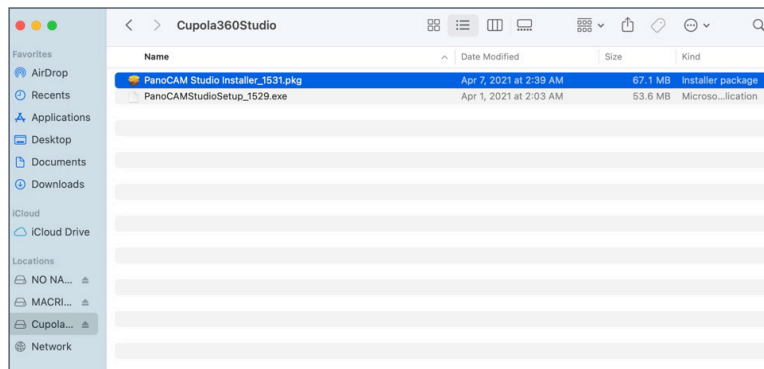

4. On the Install PanoCAM Studio Introduction screen, **click Continue.**

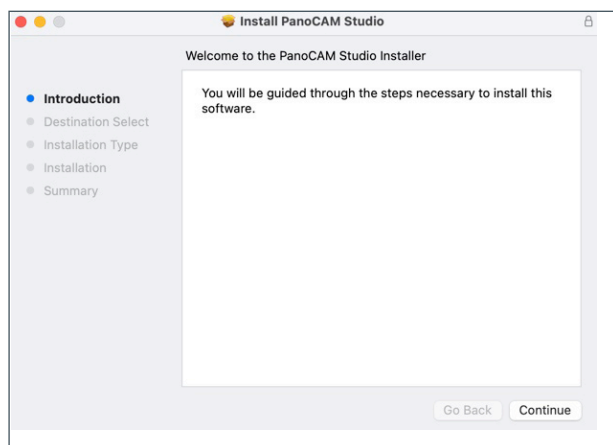

5. On the Install PanoCAM Studio Installation Type screen, **click Install.**

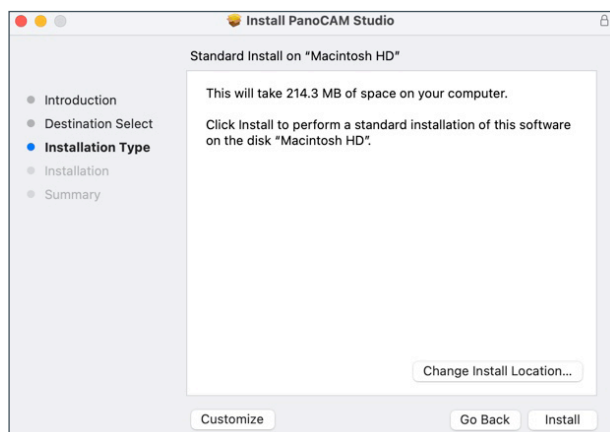

When the installation is complete, the software displays the following screen:

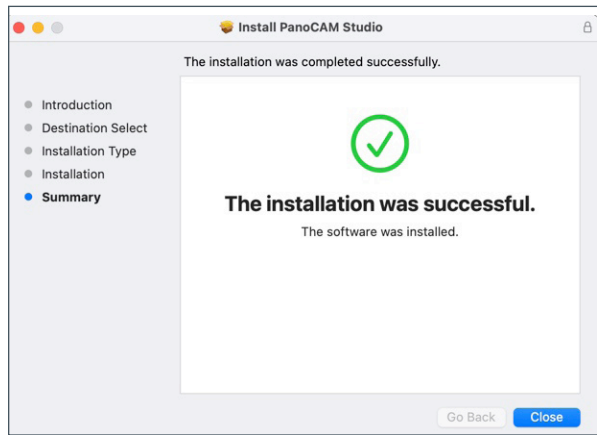

6. **Click Close.**

7. To launch PanoCAM Studio, from within Applications, **double-click** the **PanoCAM Studio icon**.

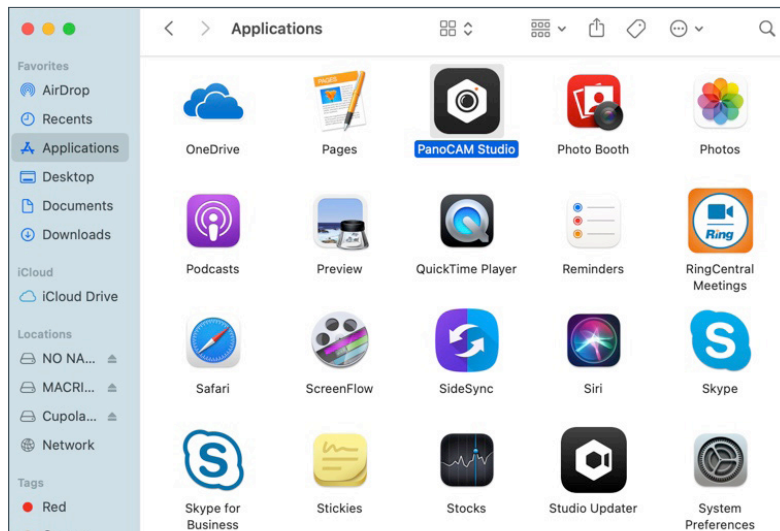

Studio activates the camera and displays a window similar to the following:

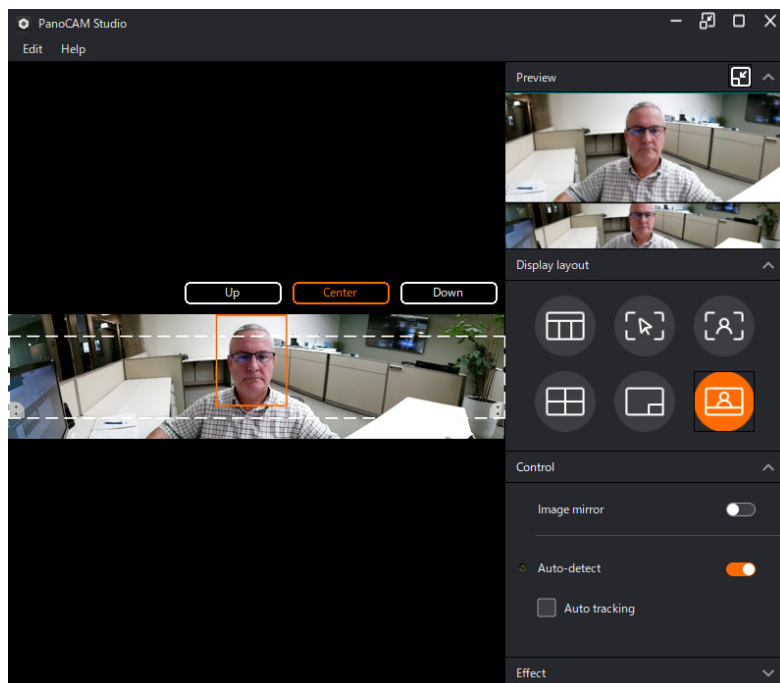

Launching Studio with Any Application

For example, if you launch Studio when you have the UNITE 180 set as your video device in COLLABORATE Space, Studio displays the following screen:

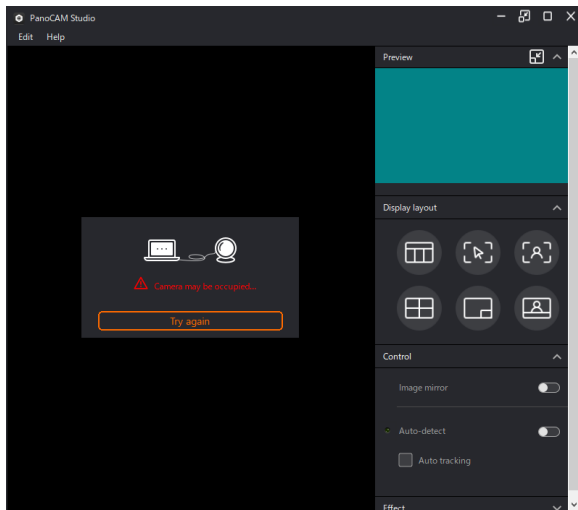

To resolve this conflict, do the following:

1. From within COLLABORATE Space, click the UNITE 180 checkbox to de-select it.

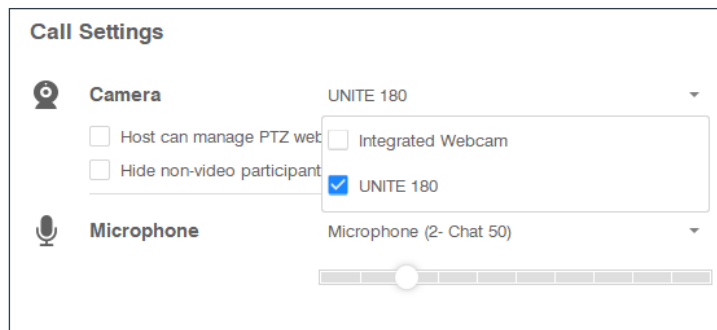

2. From within Studio, click Try Again.

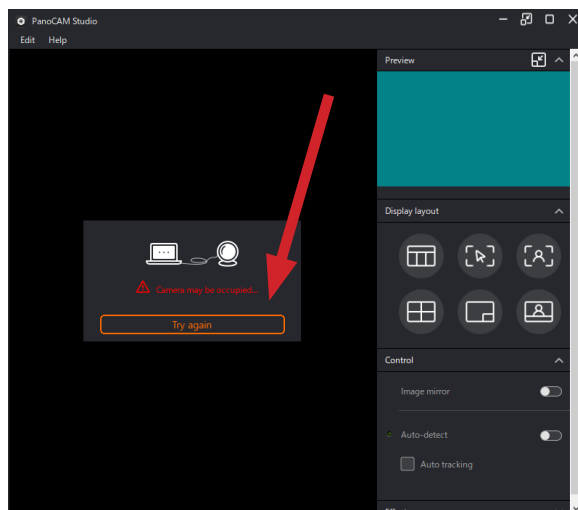

Studio is now available within COLLABORATE Space:

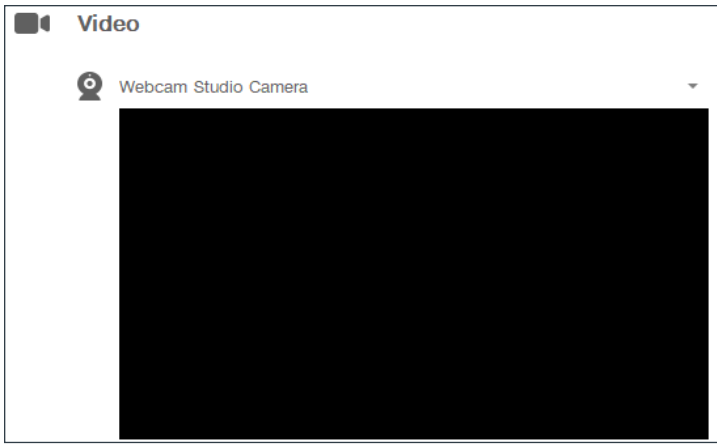

The PanoCAM Studio Interface

For quick access to a topic, click the associated number on the following images:

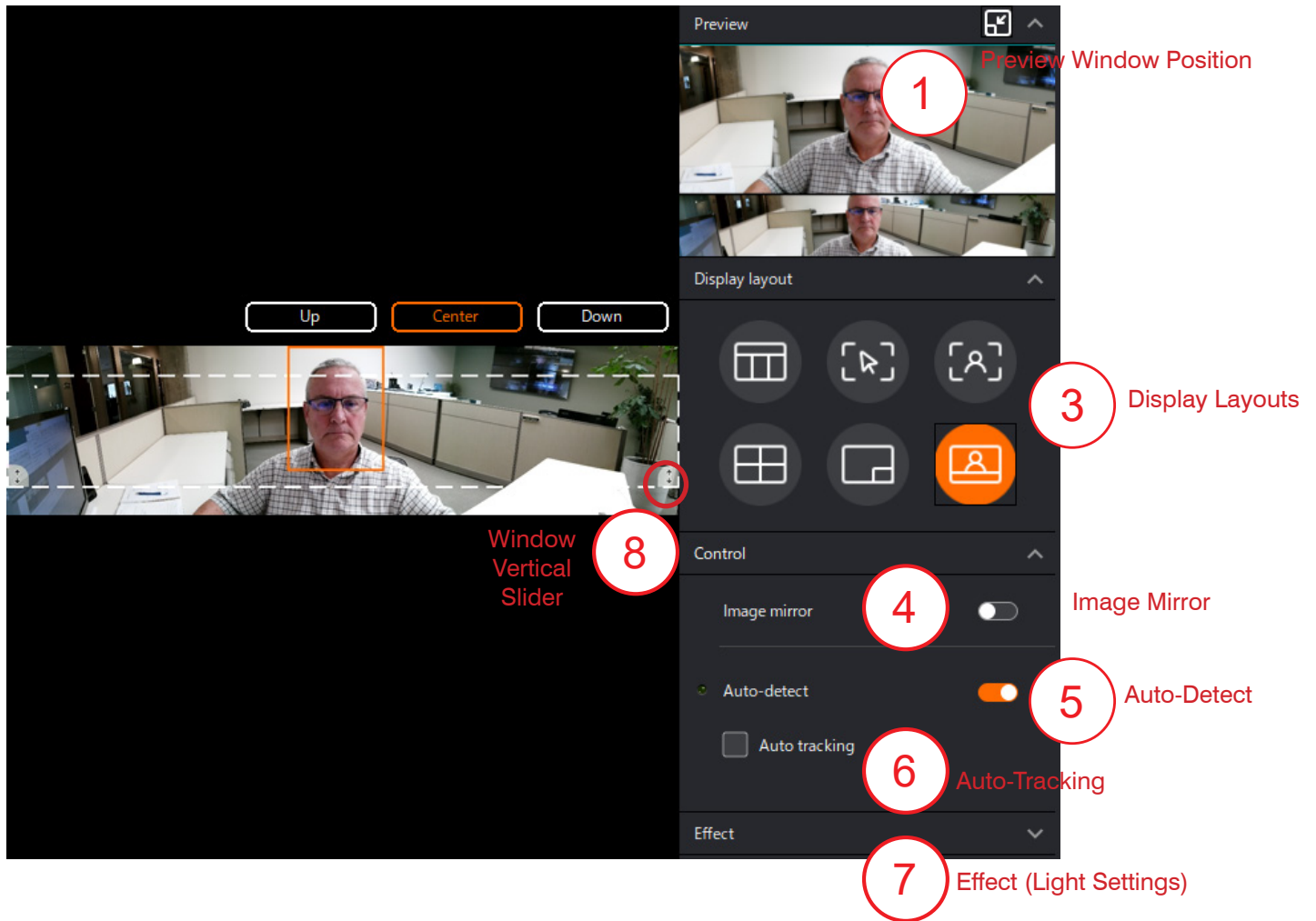

Manual Boxes

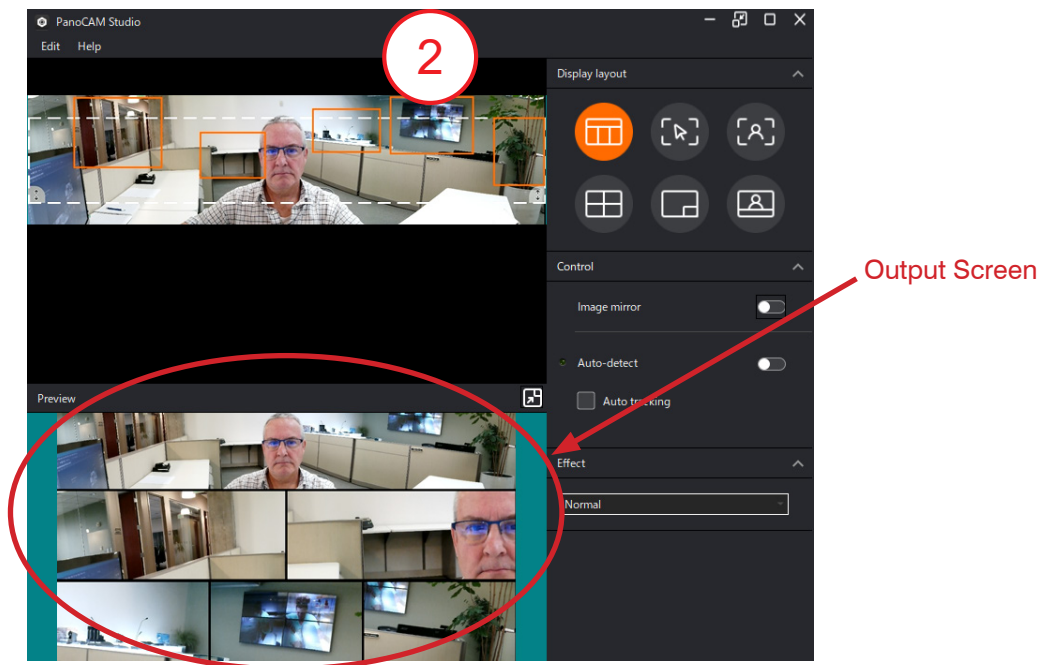

1. Preview Window Position

To move the Preview window to below the camera window, in the upper right, click the .

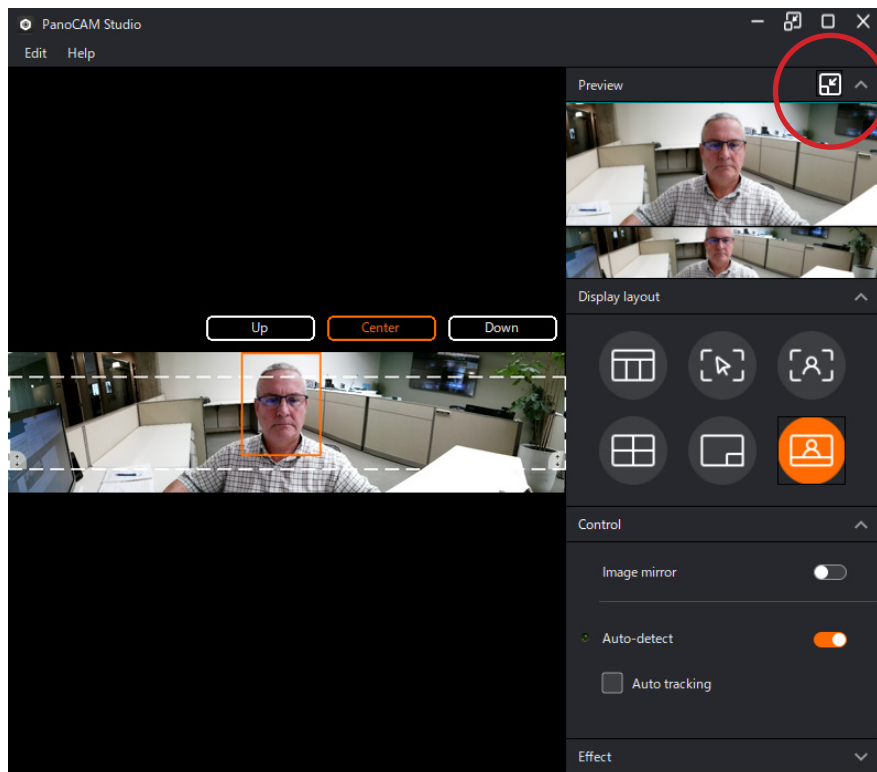

To return the preview window to the upper right, click the .

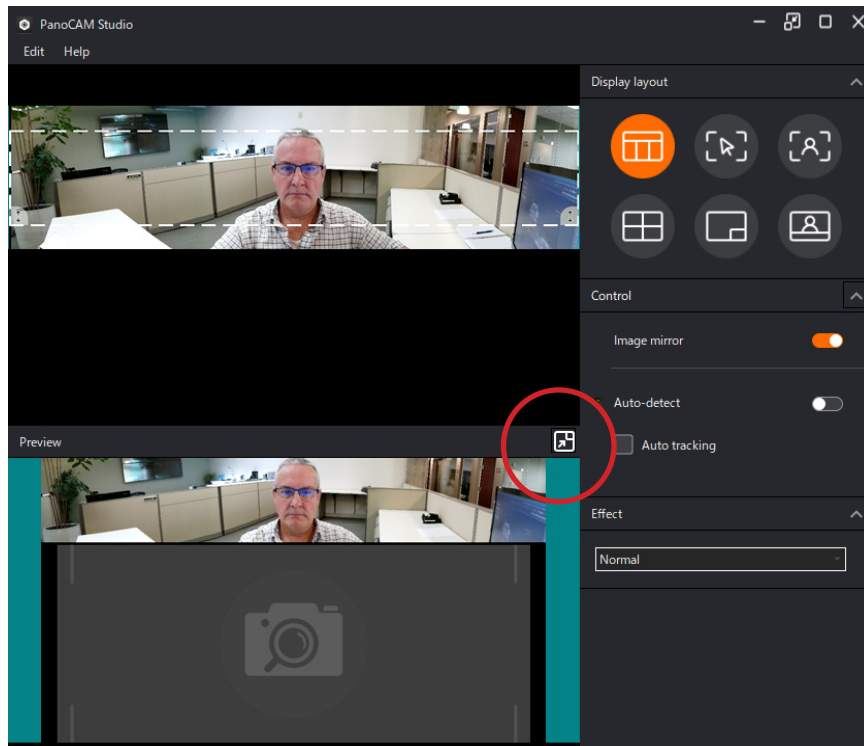

2. Manual Boxes

To create boxes manually, click on the window and diagonally drag your mouse.

To access options for boxes, click the box to select it, then right-click.

- Auto tracking. Click the checkbox to enable. The color of manual box changes to blue.
- Pin. Makes the manual box irreplaceable by another box. Click the checkbox to enable.
- Delete. Deletes the manual box.

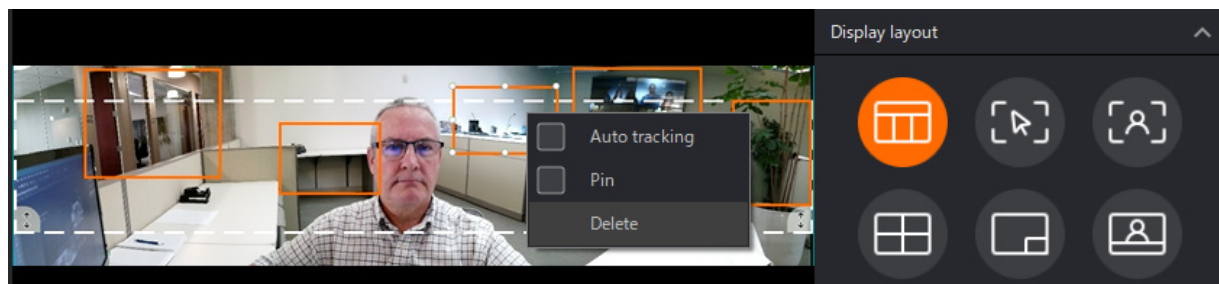

3. Display Layouts

Studio provides the following six display layouts:



Compose



Grid



Manual



Presentation



Body Fit (Autoframing Mode)



Speaker

3.1 Compose Layout

- Panoramic view on top, close-up boxes of tracked person, or manually defined boxes on the bottom.

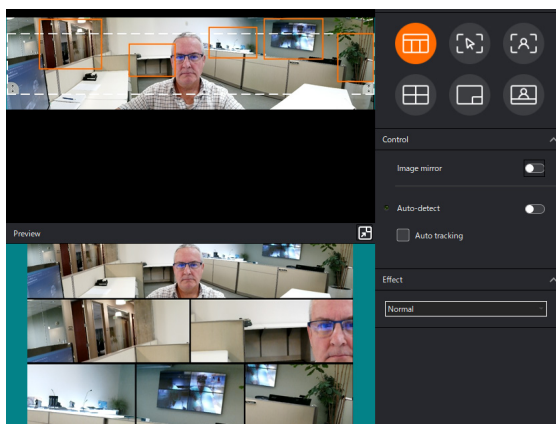

- Maximum number of close-up boxes: 8
- When the camera detects no person, and no manual box has been selected, the output area displays a panorama on the top and blank icons on the bottom.

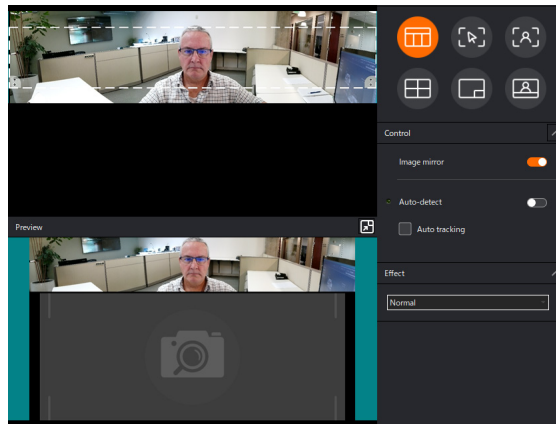

- When the detected persons or areas of a manual box selection are near each other, the system merges them into one close-up box.

3.2 Manual Layout

- The output screen displays the area of the manual box selection.
- Face tracking is **not** available with Manual layout.

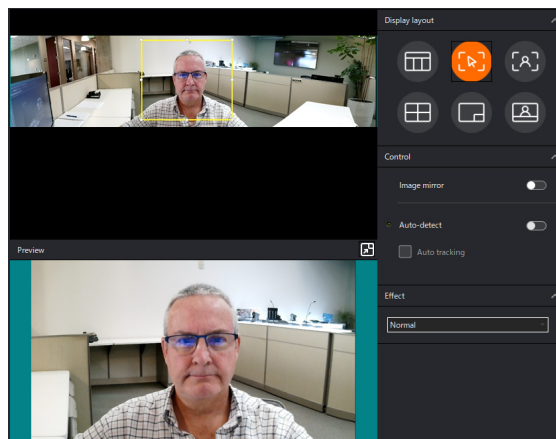

3.3 Body Fit Layout (Autoframing Layout)

- The output screen displays close-up views of each tracked person.
- When the camera detects no person, and no manual box has been selected, the output screen displays a panorama.
- The size of the manual boxes affects the width of the panorama in the output screen:

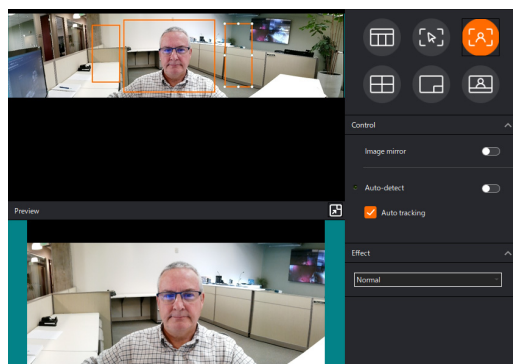

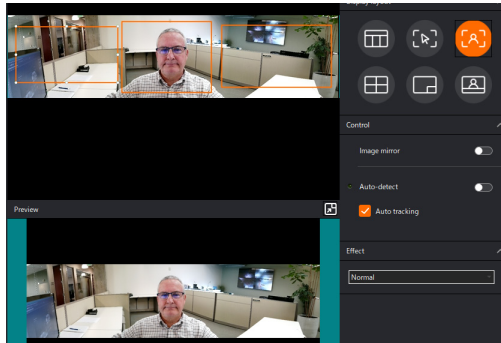

3.4 Grid Layout

- Recommended for 1 to 4 participants.
- Maximum number of close-up boxes: 4
- In the output screen, the system displays each tracked person or manual selection in a separate close-up box.
- When the camera detects no person, and no manual box has been selected, the output screen displays blank icons.
- When the detected persons or areas of a manual box selection are near each other, the system merges them into one close-up box.

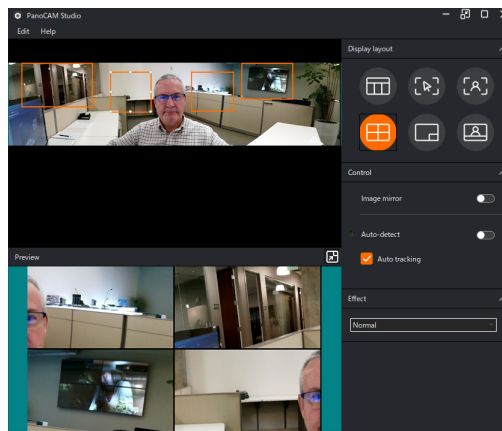

3.5 Presentation Layout

- In the output screen, the system displays a combo box, or picture-in-picture.
- When the camera detects no person, and no manual box has been selected, the output screen displays the area within the yellow box.

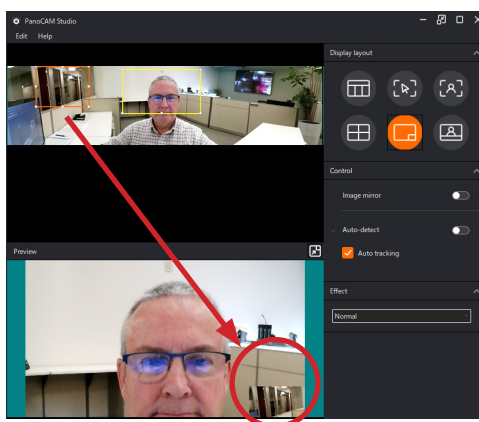

3.6 Speaker Layout

- In the top of the output screen, the system displays the detected persons;
- In the bottom of the output screen, it displays a panorama view.
- When the camera detects no person, and no manual box has been selected, the output screen displays blank icons in the top and a panorama view in the bottom.

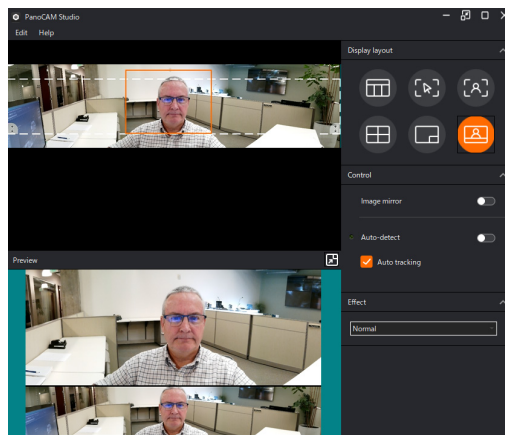

4. Image Mirror

Image Mirror Off

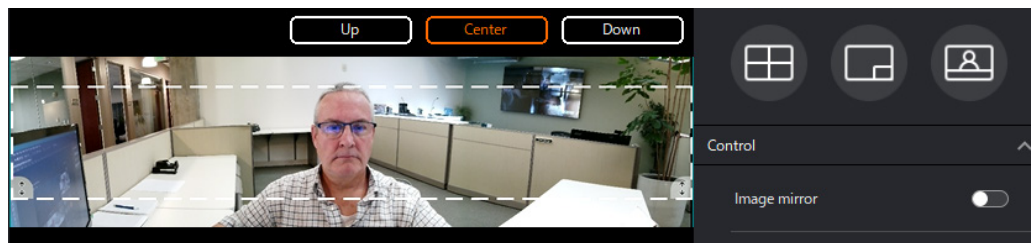
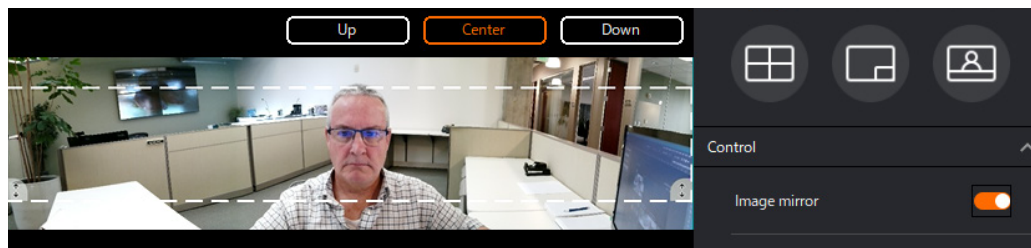
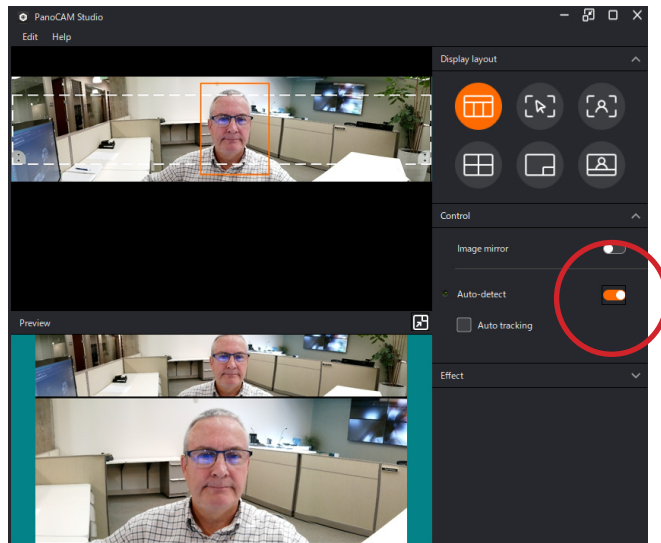

Image Mirror On



5. Auto-Detect

Auto-detect on:



Auto-detect while responding to movement:

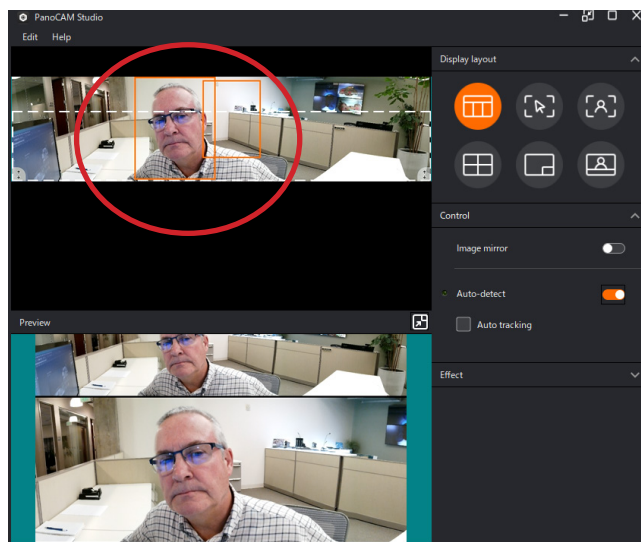

Auto-detect after responding to movement:

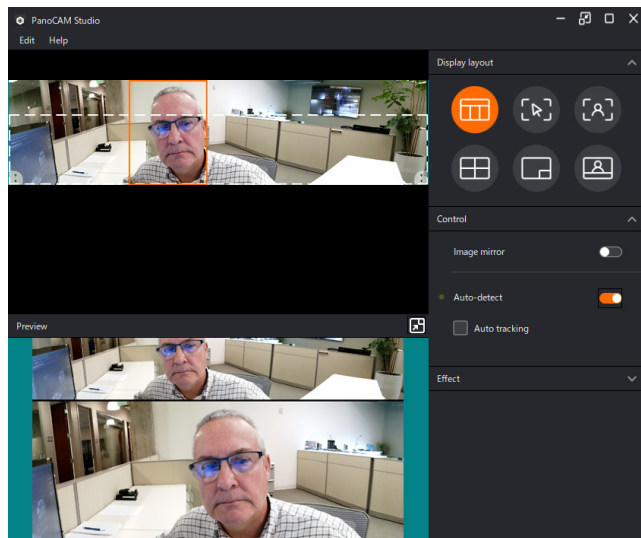

6. Auto-Tracking

Auto-tracking is similar to Auto-detect, but is more sensitive to visual changes (movement).

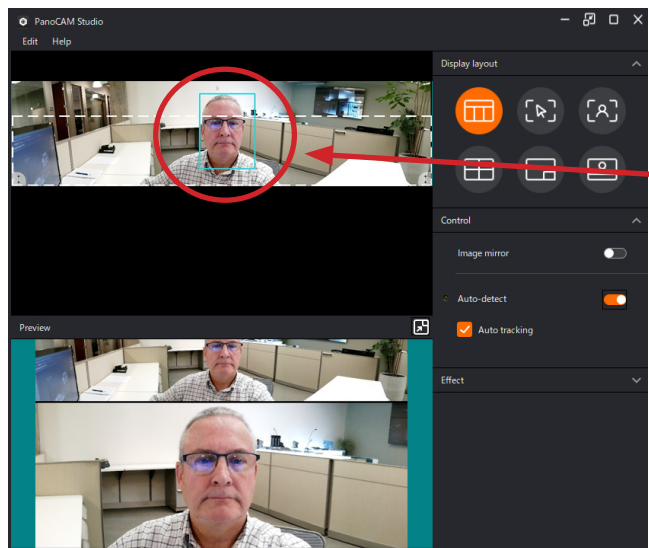

Color of box is different from color of Auto-detect box.

7. Effect (Light Settings)

Normal

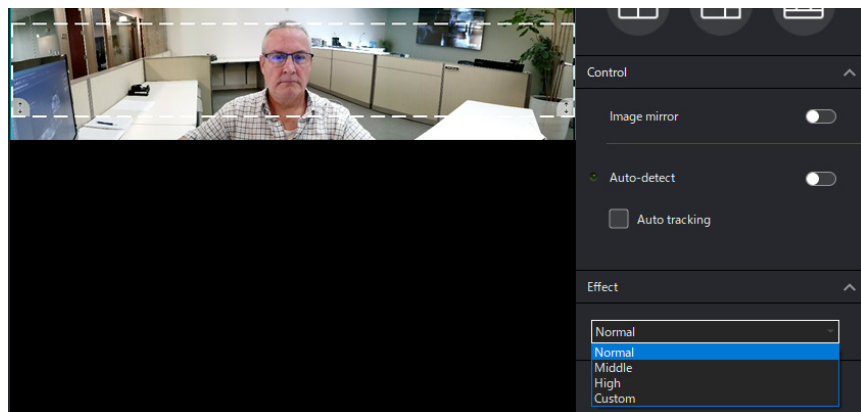

High

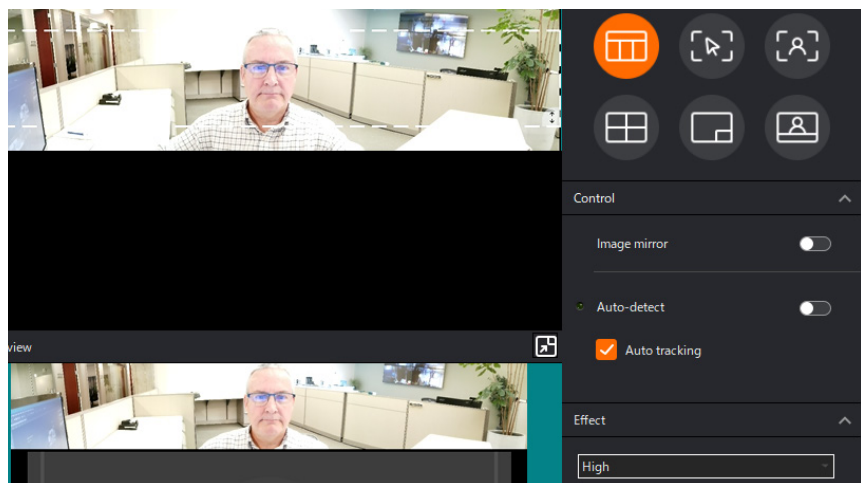

Custom Settings

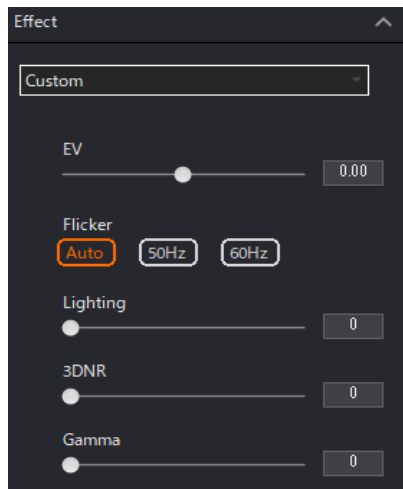

8. Window Vertical Slider

Use the Window Vertical Slider to vertically position the window (defined by white dash lines).

